



E-mail: [distributor@hyggeraquarium.com](mailto:distributor@hyggeraquarium.com)

Website: [www.hyggeraquarium.com](http://www.hyggeraquarium.com)



# automatic intelligent external canister filter user manual HG101

HG101-800L  
HG101UV-800L



HG101-1200L  
HG101UV-1200L



HG101-1800L  
HG101UV-1800L



HG101-2200L  
HG101UV-2200L



## SAVE THESE INSTRUCTIONS!

Questions, problems, missing parts?

Before returning to Amazon, email us at [mago@hygger-online.com](mailto:mago@hygger-online.com). Or visit our website at [www.hygger-online.com](http://www.hygger-online.com)

---

## PRODUCT FEATURES

- Auto priming, press button for easy operation
- Efficiently cleans and filters water
- Filter medias included
- Multi baskets of filter media
- With UV light option

## PRODUCT DESCRIPTION

### Intended use

HG101-, HG101UV-, referred to in the following as “unit”, may only be used as specified in the following:

- HG101-: Water filtering and recirculation.
- HG101UV: UV sterilizing, filtering and recirculation.
- For operation with freshwater or saltwater.
- Operation under observance of the technical data.

The following restrictions apply to the unit:

- Only use indoors and for aquarist purposes in the home (not for commercial use).
- Only operate with water at a water temperature of +39 °F to +95 °F.

## PRODUCTS SPECIFICATION:

Model	Power	Light(Watt)	Max Flow	Product Size
HG101-800L	18W	/	800L/H(211GPH)	7.1"x7.1"x11.2" (18x18x28.5CM)
HG101UV-800L		7W		
HG101-1200L	25W	/	1200L/H(317GPH)	7.1"x7.1"x14.2" (18x18x36CM)
HG101UV-1200L		7W		
HG101-1800L	35W	/	1800L/H(475GPH)	10.6"x10.6"x13.8" (27x27x35cm)
HG101UV-1800L		9W		
HG101-2200L	45W	/	2200L/H(581GPH)	10.6"x10.6"x16.1" (27x27x41CM)
HG101UV-2200L		9W		

### \*\*\*Filter Media in Scope of Delivery\*\*\*

Filter Medias Includes(Standard)				
Model	1st Basket of Filter Media	2nd Basket of Filter Media	3rd Basket of Filter Media	4th Basket of Filter Media
HG101-800L	30 ppi coarse filter foam	420 grams ceramic rings	/	/
HG101UV-800L				
HG101-1200L	30 ppi coarse filter foam	480 grams activated carbon	420 grams ceramic rings	/
HG101UV-1200L				
HG101-1800L	30 ppi coarse filter foam	480 grams activated carbon	420 grams ceramic rings	/
HG101UV-1800L				
HG101-2200L	30 ppi coarse filter foam	30 ppi coarse filter foam	480 grams activated carbon	420 grams ceramic rings
HG101UV-2200L				

# METHOD OF APPLICATION

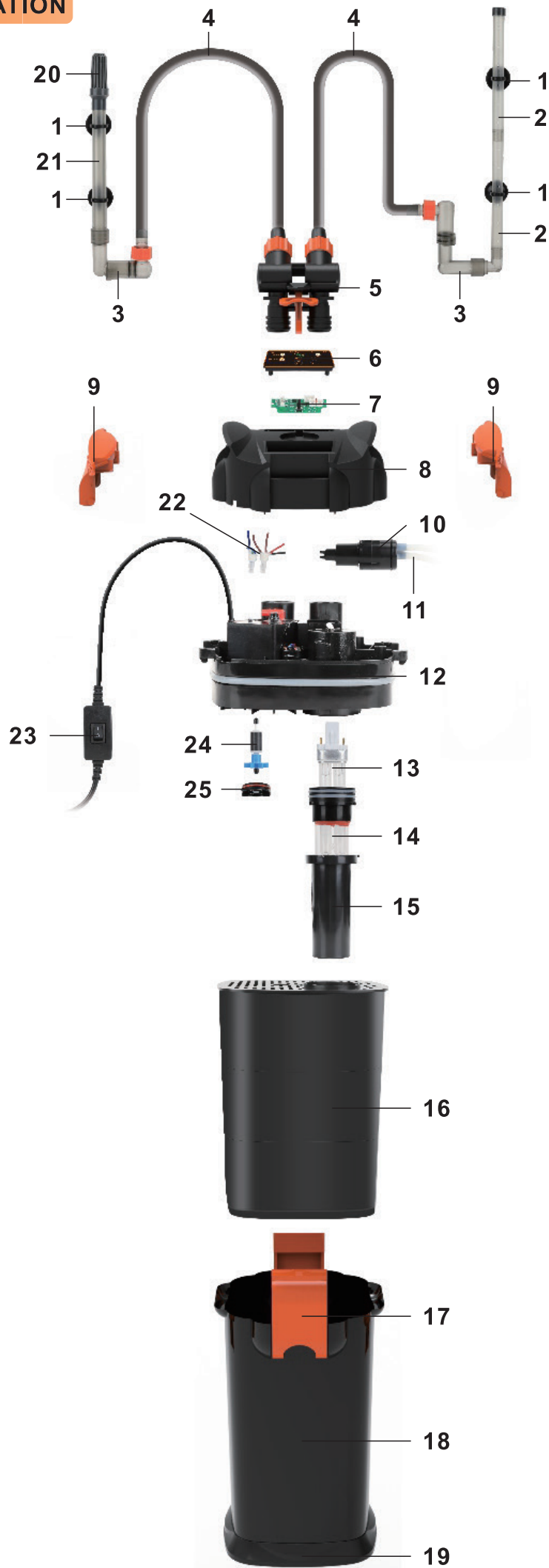

Spare Parts Listing			
Part	Description	Quantity	Remarks
1	Suction Cup for Model HG101-800L and HG101-1200L	4	/
	Suction Cup for Model HG101-1800L and HG101-2200L	6	/
2	Spray Bar for Model HG101-800L and HG101-1200L	2	/
	Spray Bar for Model HG101-1800L and HG101-2200L	3	/
3	Pipe Adapter with Lock Nut	2	/
4	Flexible Tubing (4.9ft/1.5m)	2	/
5	Inlet and Outlet Connection Unit with Check Valve	1	Assembled inside filter head
6	Circuit Board Cover Plate	1	
7	Intelligent Control Circuit Board	1	/
8	Filter Head Cover	1	/
9	Lid Fastener	1	Assembled inside filter head
10	Priming Pump	1	
11	Suction and Priming Hose	1	
12	Motor Base	1	Assembled inside filter head
13	UV Lamp	1	
14	Glass Protect Cover	1	
15	Lamp Cover	1	/
16	Media Baskets	2	/
17	Fastener Clamps	1	/
18	Canister Filter Unit	1	/
19	Canister Filter Base	1	/
20	Inlet Strainer	1	/
21	Adjustable Inlet Pipe	1	
22	Water Level Sensor Probe	1	Assembled inside filter head
23	UV Lamp Switch	1	/
24	Motor Impeller	1	Assembled inside filter head
25	Impeller Lid	1	

## ACCESSING THE UNIT



CAUTION

The following applies to all units with a UV light:  
Adhere to the rules for careful handling of the UV light.



CAUTION

DO not stare at the plug in UV lamp  
Always unplug ultraviolet lamp before take it out.



CAUTION

Do not touch the lamps with bare hands when handling them. We recommend using gloves as a usual norm.



CAUTION

**Risk of breaking the lamp!**  
The UV bulb can break and cause cuts.

- Take care when handling the lamp.
- Always allow the lamp to cool properly once it have been turned off.
- Take care of glass fragility when installing the lamp

## The UV lamp has to be removed for cleaning, maintenance

Removing the UV lamp (HG101UV- models)

How to proceed:

1. Lift up the filter head.  
Twist the black lamp protector-clockwise and pull up.



2. Wearing gloves twist the transparent lamp protector-clockwise and pull up the lamp.



## INSTALLATION AND USE



1. Loosen and disengage the fourth lid fasteners



\*If you are unable to loosen filter lid fasteners, you can grab the lid and do you best to pull it out.



2. Remove the filter lid and set it aside.
3. Using the handles, lift the media baskets from the filter canister.



4. Rinse baskets, media trays and media materials under running tap water to remove any dust, and place media back in their original position. Or, if you prefer, select other media of your own choosing.



5. After installing and pressing the filter head on the product, lock the clamping clips and install the inlet/outlet set.



6. Press the retaining ring down, plug in the power supply and start filtering.

### IMPORTANT:

- NEVER overfill baskets. Leave at least 0.5 in. (1cm) of free space from the top of the baskets to the media, so the baskets will fit together properly.
- Hosing must follow a straight path from the filter to the aquarium rim, with no slack and no loops.
- For best performance, the filter should be completely beneath the aquarium.
- Make certain that each kind of media is positioned at the same level it was packaged in.
- Stack the baskets, carefully aligning them, so that all shapes match.
- Move the filter canister to its final position.
- Place the filter lid back on the canister. Check to make sure the filter lid seal ring is present and installed properly on the canister lid. There is only one orientation possible. Gently press the lid down fasten with 4 lid fasteners.



### Installation of the intake and output valve lever

- Inset the orange buckle onto the inlet and outlet valve lever.
- Grasp the intake and outlet valve lever (which is at the end of the hosing attached to the intake tube and outlet tube); slide it onto the IN/OUT connection on the filter lid, and press the orange buckle down until it clicks into place.

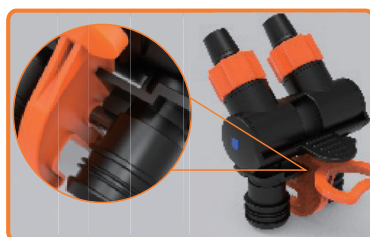

FIG1



FIG2



FIG3

**IMPORTANT:** Be certain intake and outlet lever is locked in place before proceeding.

**CAUTION:** Always unplug any appliances from an outlet and leave the valve in the OFF position when not in use before putting on or taking off parts, and before cleaning. An open valve will result in an immediate water spill.



## PREPARE INTAKE CONNECTIONS

1. Connect the hosing to one of the two valves (marked "IN"):
  - A. Loosen one of the clamps, and slide it onto one end of the hosing (the rubber part).
  - B. Push the end of the hosing onto the valve; push it all the way, as far as it will go.
  - C. Position the clamp over the rubber connector, and tighten.
2. Measure and cut the hosing. You will need a length of hosing that reaches comfortably from inside the aquarium to the filter canister.

### IMPORTANT:

Hosing should follow a straight path from the filter to the aquarium rim, with no slack and no loops. If the hosing is too long, the filter will not work efficiently (the maximum length of the hosing is 4.9ft / 1.5m).

- D. Place the valve end of the hosing at the approximate spot where it will be positioned on the filter lid (once the filter is installed).
  - E. Stretch out the hosing so it rests over the "intake" rim bracket.
3. Push the cut end of this "intake" hosing into the rubber connector on the intake tube. Push the hosing in by at least 1 in. (2.5cm) without twisting it.
  4. Place the intake strainer in the tank, making sure it is at least 3 in. (7.5 cm) from the bottom. Adjust the intake tube for the best extension for your aquarium, respecting the 3 in. (7.5 cm) from the bottom rule. Once the intake strainer is properly positioned, lock it in place by pressing the suction cups against the glass.
  5. Fasten the inlet strainer onto the suction cup .

## PREPARE OUTPUT CONNECTIONS

1. Connect the hosing to the second valve (Just as for the intake hosing):
  - A. Loosen the second clamp, and slide it onto the factory-finished end of the hosing (not the cut end).
  - B. Push the end of the hosing onto the valve; push it all the way, as far as it will go.
  - C. Position the clamp over the rubber connector, and tighten.
2. Measure and cut the hosing. Again, you will need a length of hosing that reaches comfortably from inside the aquarium to the filter canister.

### IMPORTANT:

Hosing should follow a straight path from the filter to the aquarium rim, with no slack and no loops. If the hose is too long, the filter will not work efficiently.

3. Place the valve end of the hosing at the approximate spot where it will be positioned on the filter lid (once the filter is installed).
4. Stretch out the hosing so it rests over the "output" rim bracket.
5. At a spot at least 6 in. (15cm) beyond the aquarium rim, use a utility knife to cut the hosing. Do not cut it too short. Remember, you can always cut it shorter during final installation, if necessary.
6. Push the cut end of this "output" hosing into the rubber connector of the output nozzle. Push the hosing in by at least 1 in. (2.5cm) without twisting it.
7. Place the nozzle in the tank about 1 in. (2.5cm) below the water line.
8. Fasten the hosing to the "output" bracket using the two suction cups.



## PREPARE THE AQUARIUM

1. The distance between the aquarium water surface level and the bottom of the canister filter body should be no more than 5.9 ft(180CM) maximum. According to the principle of atmospheric pressure, water will automatically flow into the canister filter after startup, so it is necessary to install the body below the water surface level.





**MAX:70.9inches(180cm)**

**IMPORTANT:**

- NEVER install the filter above the water level

**START THE FILTER**

Before turning the filter on, be sure that:

- A. The water inlet and outlet valve is turn on.
- B. All top lid fasteners are well tightened.

There is no need to pre-filled with water inside the canister or intake strainer.

1. Open the IN & OUT valve levers placing them in the vertical position.
2. Plug the unit into an electrical outlet. Keep pressing set button until auto priming indicator light is on. The electronic automatic priming sequence will begin. This is what will happen:
  - C. The pump will run for 1 minute to fill the filter canister with aquarium water and evacuate air from the filter canister.
  - D. The pump will remain on and will run continuously until it is unplugged. This sequence will repeat itself every time the unit is unplugged and plugged back in.

1. UV lamp indicator light
2. Auto priming indicator light
3. Manual priming indicator light
4. Set button – to switch from auto priming and manual priming
5. UV button- to turn on/off UV lamp (For HG101UV- series only)



**START UV STERILIZATION (FOR HG101UV-SERIES ONLY)**

How to proceed:

Press UV button, you can see UV lamp indicator light is on. Press UV button again to turn it off.

**IMPORTANT:** We suggest to turn on UV lamp two hours and turn it off everyday.

**IMPORTANT**

To ensure optimal and proper functioning of your hygger canister filter, regular maintenance is required. Failure to do so may result in the failure of the filter and will invalidate your warranty. Additionally, regular cleaning and maintenance will greatly reduce or completely prevent faults and reduction in performance. Please refer to the maintenance schedule below

## MAINTENANCE FREQUENCY CHART

COMPONENTS	MONTHLY	EVERY 3 MONTHS	EVERY 6 MONTHS	YEARLY
Magnetic Impeller		Check & Clean		Replace
Motor Seal Ring		Check & Clean		Replace
Intake Stem/Strainer		Check & Clean		
Hose		Check & Clean		
Coarse Foam		Check & Clean	Replace	
Ceramic Rings	Rinse		Replace half quantity	
Activated Carbon	Replace			
Canister (inside)*	Check & Clean			

### FILTER MAINTENANCE

Prior to periodic maintenance the canister must be unplugged.

#### **Disassemble the unit**

1. Move the filter to an appropriate area convenient for maintenance.
2. Loosen and remove the four lid fasteners; remove the filter lid and set aside. Be careful not to damage the inlet stem connected to the lid.
3. Lift the media baskets from the filter canister.

#### **Cleaning or replacing media**

1. Remove all foam inserts from the media baskets and trays, rinse using aquarium or de-chlorinated tap water, or replace with new foam, as required.
2. Rinse biological media with aquarium water, or replace, as required.
3. Replace chemical media, as needed. Chemical media cannot be cleaned.
4. Empty and rinse the filter canister. NEVER use soap or detergents when cleaning the canister or rinsing the baskets and trays, as remaining traces of cleaning products may damage sensitive fish tissue.
5. NEVER overfill baskets. Leave at least 0.5 in. (1cm) of free space from the top of the baskets to the media, so the baskets will fit together properly. If the tray is present, the media at the bottom of the basket must not exceed the height of the tray supports in the basket.

### IMPELLER MAINTENAN

Prior to performing pump care the filter must be unplugged.

#### **To loosen 4 fastener clamps open the filter lid:**

- A. Place the filter lid upside down on a secure work area so that the impeller lid is visible. Remember that the UV lamp protect protrudes from the top rim of the canister. Be sure not to bend or damage the protector while it is upside down.
  - B. Twist the impeller lid clockwise to get the impeller.
  - C. Remove the impeller assembly by grasping the fan and drawing it gently from the well.
2. Clean the impeller and the impeller well thoroughly by rinsing with clear running water.
  3. Re-assemble all pump components with care.

**IMPORTANT:** Make sure that the seal ring does not slip out of its seat.



FIG1: Twist the impeller lid clockwise



FIG2: Take out the impeller for cleaning

## TROUBLESHOOTING

Malfunction	Cause	Remedy
Unit does not start up	Baskets placed in wrong direction	Correct place baskets
	Baskets not lined up in same positions	Stack the baskets, aligning them so all shapes match
	Overfill baskets	Remove the extra filter medias
Leakage	The clamps are not correctly lock	Lock the clamps
	Seal ring soiled	Clean
	The seal ring damage	Replace seal ring
Impeller not working	Impeller unit worn	Replace the impeller unit
	Impeller shaft damage	Replace Impeller shaft
	Impeller unit soiled	Clean
Insufficient water flow	Filter media in the filter unit soiled	Clean
	Impeller unit soiled	Clean
	Impeller unit worn	Replace the impeller unit
	Pipe soiled	Clean inlet assembly, outlet assembly, and tubing
	hose kink	Straighten up the hose
	Foam soiled	Clean
	Inlet strainer clogged	Clean
	The flow is not correctly set	Correct the setting
Insufficient filtering performance	Foam soiled	Clean
	Foam worn	Replace
	Filter media in the filter unit soiled	Clean
	Filter media in the filter unit worn	Replace
Increased noise	Air in the hose	Shake the filter to vent air
	Air in the Filter is not below the surface of the water	Shake the filter body to vent air
	Filter is not below the surface of the water	Install the filter below the surface of the water
	Debris in the motor/impeller	Clean the motor/impeller
	Impeller shaft damage	Replace the impeller shaft

## ONE YEAR LIMITED WARRANTY

This product MUST be purchased from an authorized hygger reseller. Visit our website for a list of authorized resellers. hygger warrants this product against defects in materials and workmanship for ONE(1) YEAR from the date of the original retail purchase and is none-transferable.

Warranty on all products, including aquariums. But it is limited to the replacement of the products and does not cover fish loss, personal injury, property loss or direct, incidental or consequential damage caused by using this product.

Note: hygger One-year Limited Warranty does not cover damage caused by the followings: improper installation, saltwater corrosion, electrical surges or modifications. Additionally, products that have been refunded are also not covered under the warranty.

If you discover a defect, please contact hygger, who will, at it's option, repair or replace the product at no charge, provided that you return it during the warranty period. A copy of the bill of sale is required as a proof of the original purchase date in the event of the product needing repairs within the warranty period. hygger does not warrant any products that aren't hygger's.

This warranty does not apply if the product has been damaged by accident, abuse, misuse or misapplication, or modified without the written permission of hygger.

## WEAR PARTS

The following components are wear parts and are excluded from the warranty:

- Filter media
- Impeller unit
- Suction cups

## DISPOSAL

Do not dispose this product as unsorted municipal waste. Collection of such waste separately for special treatment is necessary. This product has to be disposed at an authorized place for the recycling of electrical and electronic appliances rather than being disposed together with the domestic waste. Collecting and recycling waste is a way of saving natural resources. So, please consult with your local seller to make sure the product is disposed in an environmentally friendly way.

## CONTACT INFORMATION

Distributed by:Hygger Aquarium, Inc.  
13941 Magnolia Ave, Chino, CA 91710

E-mail: [distributor@hyggeraquarium.com](mailto:distributor@hyggeraquarium.com)

Website: [www.hyggeraquarium.com](http://www.hyggeraquarium.com)

Trademarks of Shenzhen Mago Trading Co.,Ltd  
Bantian Group Business Center,Longgang,  
Shenzhen City, China  
All Rights Reserved

Made in China